

# Asbestos Blockplan

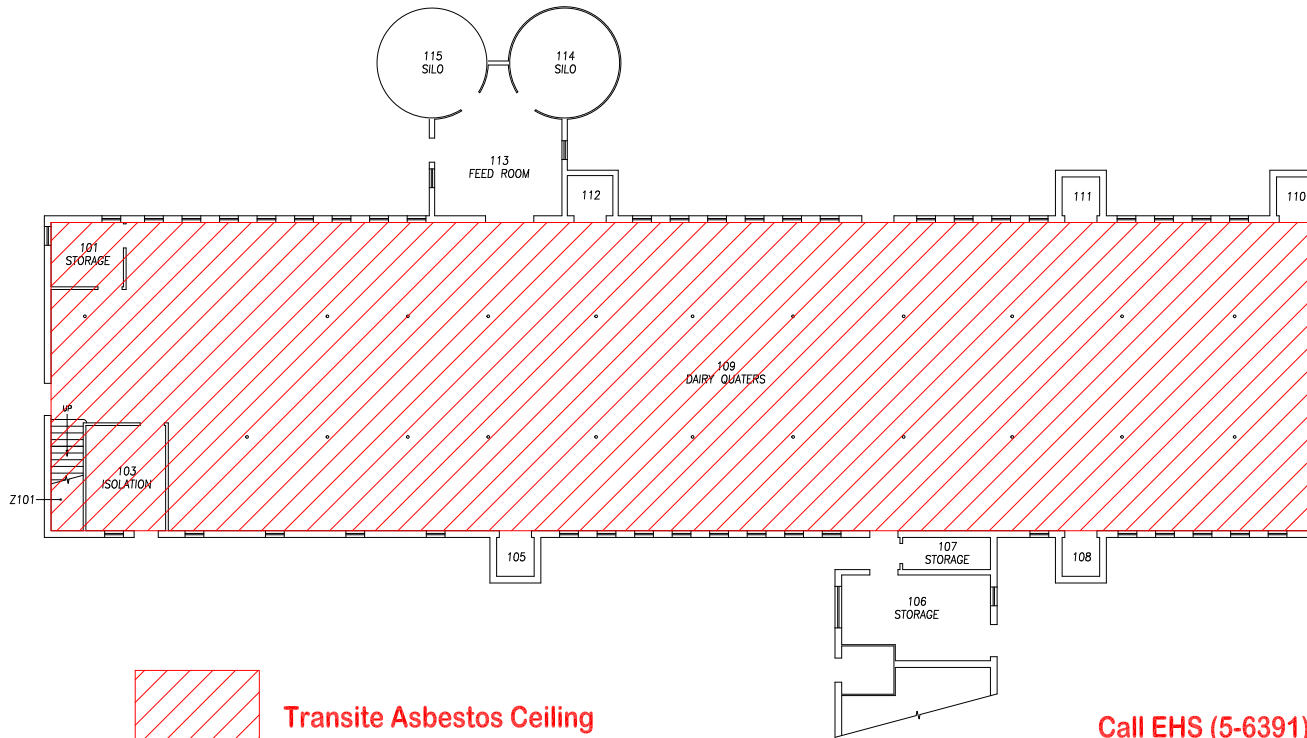

 **Transite Asbestos Ceiling Panels**  
Revised: 1/17/13

**Call EHS (5-6391) BEFORE accessing above drop ceilings**

**NOTE: Asbestos Pipe Insulation, Floor Tile and other Information can be found on the EHS Website: [www.ehs.psu.edu](http://www.ehs.psu.edu)**

## DAIRY BARN C (D-7)

FIRST FLOOR PLAN

UNIVERSITY PARK CAMPUS, UNIVERSITY PARK, PA

**PENNSYLVANIA STATE UNIVERSITY**



FACILITIES RESOURCES AND PLANNING  
THE PENNSYLVANIA STATE UNIVERSITY  
BENEDICT HOUSE  
UNIVERSITY PARK, PA 16802

OFFICE: 814.865.1595 FAX: 814.865.1610 [www.facilities.psu.edu](http://www.facilities.psu.edu)

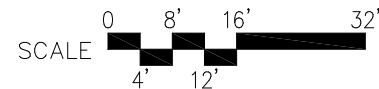

12/28/97

1/31/12

CAUTION: Campus block plans are for referential use only. Drawings are not to be used for architectural engineering purposes.

0168-003

1 OF 2

1

# Asbestos Blockplan

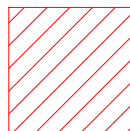
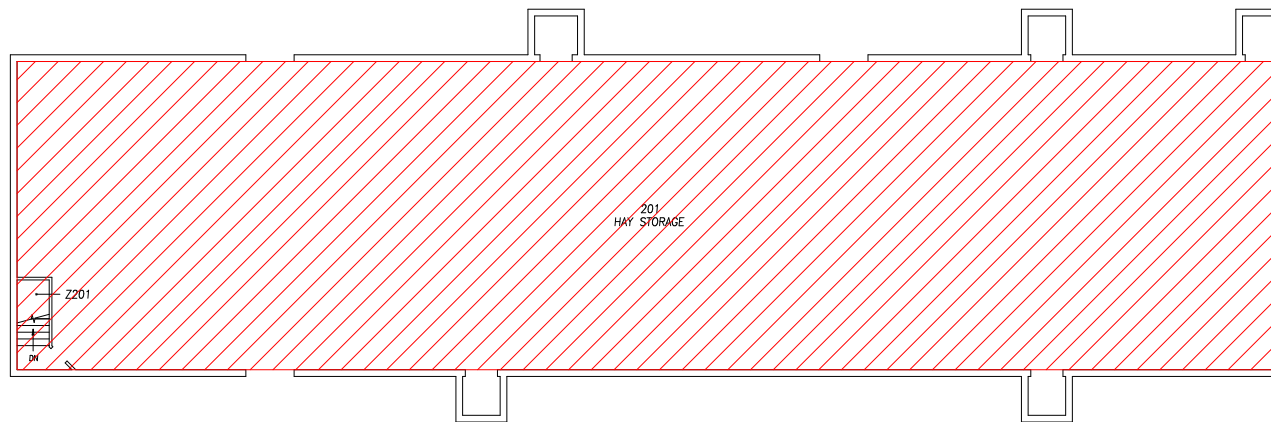

**Transite Asbestos Ceiling Panels**  
Revised: 1/17/13

**Call EHS (5-6391) BEFORE accessing above drop ceilings**

**NOTE: Asbestos Pipe Insulation, Floor Tile and other Information can be found on the EHS Website: [www.ehs.psu.edu](http://www.ehs.psu.edu)**

**DAIRY BARN C (D-7)**

**SECOND FLOOR PLAN**

UNIVERSITY PARK CAMPUS, UNIVERSITY PARK, PA

**PENNSTATE**



FACILITIES RESOURCES AND PLANNING  
THE PENNSYLVANIA STATE UNIVERSITY  
BENEDICT HOUSE  
UNIVERSITY PARK, PA 16802

OFFICE: 814.865.1595 FAX: 814.865.1610 [www.facilities.psu.edu](http://www.facilities.psu.edu)

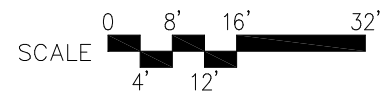

12/28/97

1/31/12

Compass block plans are for referential use only. Drawings are not to be used for architectural engineering purposes.

**0168-003**

**2 OF 2**

**2**

# Asbestos Blockplan

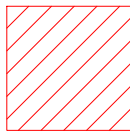
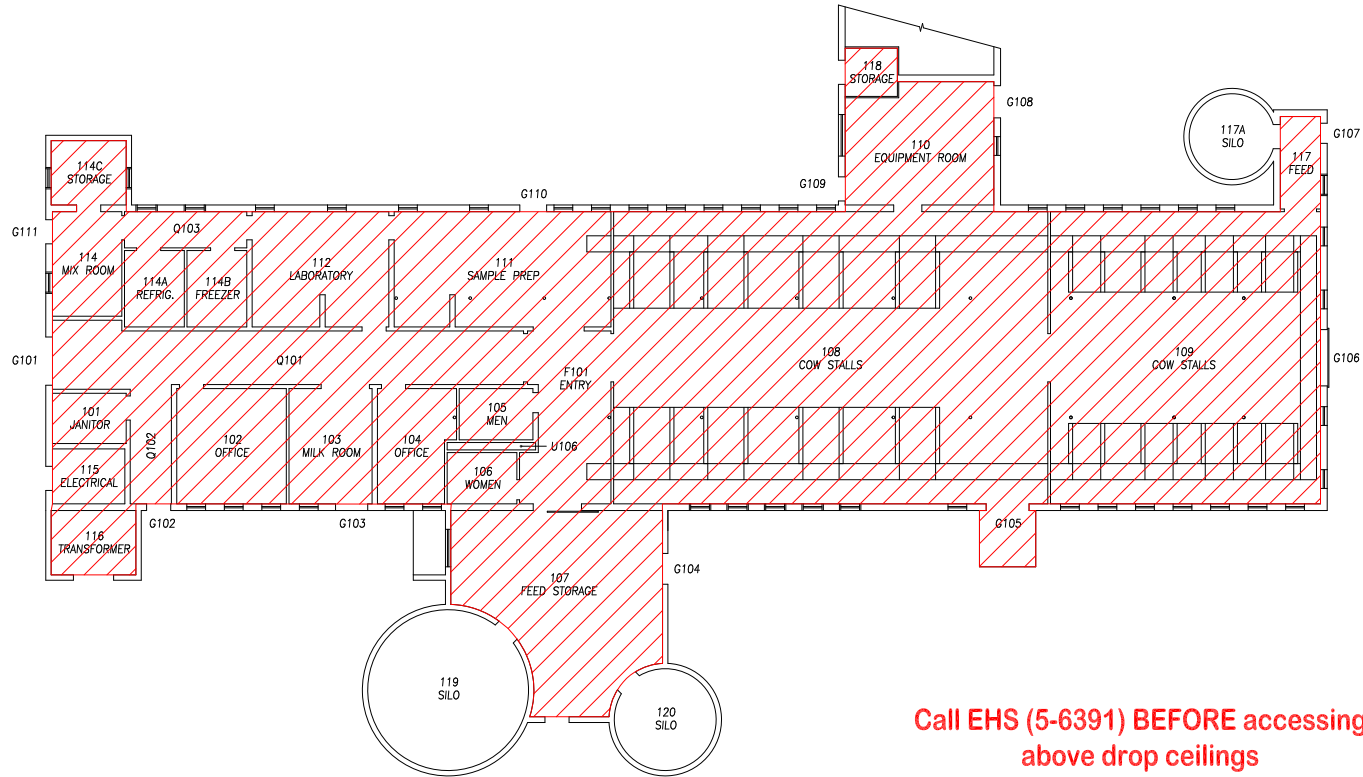

**Transite Asbestos Ceiling Panels**  
Revised: 1/17/13

**Call EHS (5-6391) BEFORE accessing above drop ceilings**

**NOTE: Asbestos Pipe Insulation, Floor Tile and other Information can be found on the EHS Website: [www.ehs.psu.edu](http://www.ehs.psu.edu)**

**DAIRY BARN D (D-8)**

FIRST FLOOR PLAN

UNIVERSITY PARK CAMPUS, UNIVERSITY PARK, PA

**PENNSTATE**



FACILITIES RESOURCES AND PLANNING  
THE PENNSYLVANIA STATE UNIVERSITY  
BENEDICT HOUSE  
UNIVERSITY PARK, PA 16802

OFFICE: 814.865.1595 FAX: 814.865.1610 [www.facilities.psu.edu](http://www.facilities.psu.edu)

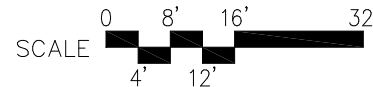

12/29/97

1/31/12

Compass block plans are for referential use only. Drawings are not to be used for architectural/engineering purposes.

**0168-004**

**1 OF 1**

**1**

# Asbestos Blockplan

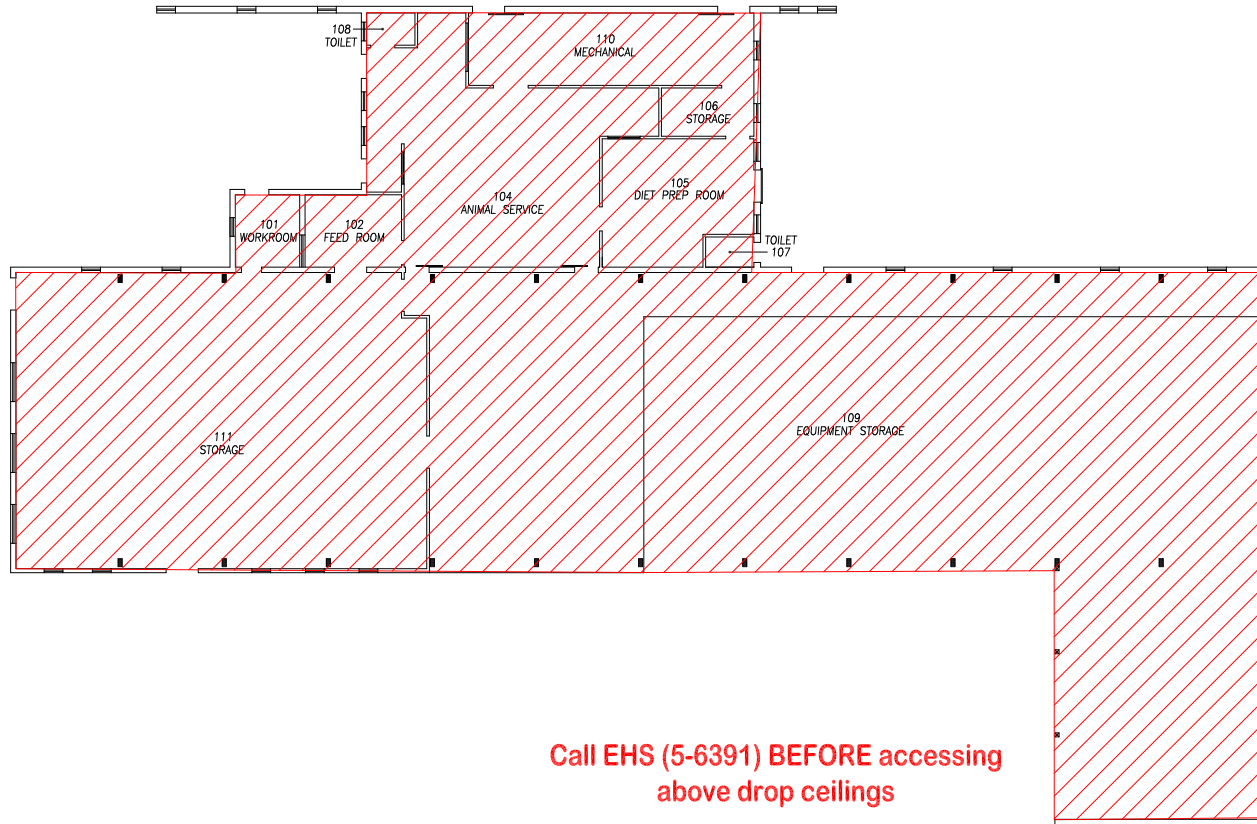

**Call EHS (5-6391) BEFORE accessing above drop ceilings**



**Transite Asbestos Ceiling Panels**  
Revised: 1/17/13

**NOTE: Asbestos Pipe Insulation, Floor Tile and other Information can be found on the EHS Website: [www.ehs.psu.edu](http://www.ehs.psu.edu)**

## DAIRY BARN F (D-10)

FIRST FLOOR PLAN

UNIVERSITY PARK CAMPUS, UNIVERSITY PARK, PA

**PENNSSTATE**



**FACILITIES RESOURCES AND PLANNING**

THE PENNSYLVANIA STATE UNIVERSITY  
BENEDICT HOUSE  
UNIVERSITY PARK, PA 16802

OFFICE: 814.865.1595 FAX: 814.865.1610 [www.facilities.psu.edu](http://www.facilities.psu.edu)

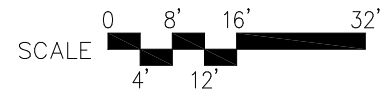

12/29/97

1/31/12

These drawings are for  
referential use only. Drawings are  
not to be used for architectural  
engineering purposes.

**0168-006**

**1 OF 1**

**1**