

Asbestos Blockplan Eisenhower Auditorium

DO NOT PRINT THESE BLOCKPLANS AND ASSUME CHANGES NEVER OCCUR. UPDATES ARE CONSTANTLY BEING ADDED.

These blockplans DO NOT include the following asbestos containing materials:

Thermal insulations such as pipe, boiler, tank, or duct insulation; these are assumed to contain asbestos unless they are obviously fiberglass or foam rubber.

ALL resilient floorings are also assumed to contain asbestos (i.e. 12"x12" and 9"x9" Floor Tile, Linoleum, etc.).

ALL Soapstone Lab Bench Tops are also assumed to contain asbestos.

Many of these materials are above drop ceilings and are not readily visible. Specific locations of these materials can be obtained by calling Environmental Health and Safety at 5-6391 (3-1111 after 5 P.M.).

Asbestos Blockplan

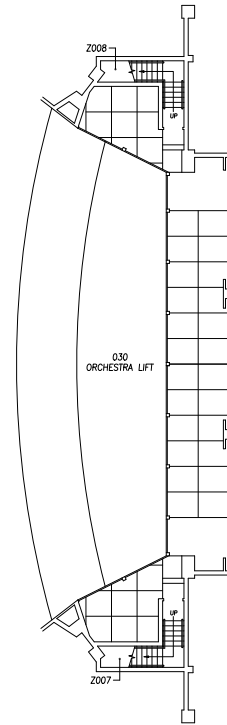
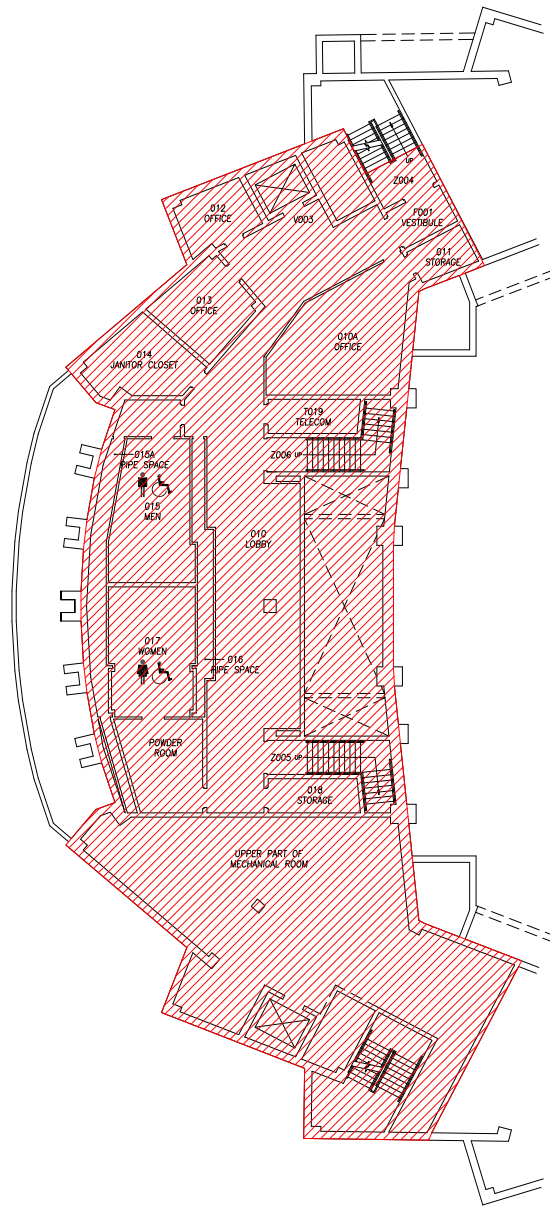

 Spray-on Asbestos Fireproofing / Overspray
Revised: 1/17/13

Call EHS (5-6391) BEFORE accessing above drop ceilings

Note: Spray-on Asbestos Fireproofing also assumed to be above all drop plaster ceilings.

Note: Asbestos Pipe Insulation, Floor Tile and other Information can be found on the EHS Website: www.ehs.psu.edu

EISENHOWER AUDITORIUM

FOR REMOVAL ONLY
BASEMENT FLOOR PLAN
UNIVERSITY PARK CAMPUS, UNIVERSITY PARK, PA
FOR CAMPUS LOCATION

PENNSTATE



FACILITIES RESOURCES AND PLANNING
THE PENNSYLVANIA STATE UNIVERSITY
BENEDICT HOUSE
UNIVERSITY PARK, PA 16802
OFFICE: 814.865.1595 FAX: 814.865.1610 www.facilities.psu.edu

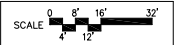

03/17/98 02/18/10
DATE DATE
Campus block plans are for referential use only. Drawings are not to be used for architectural or engineering purposes.

0011-00

2 OF 7

B

Asbestos Blockplan

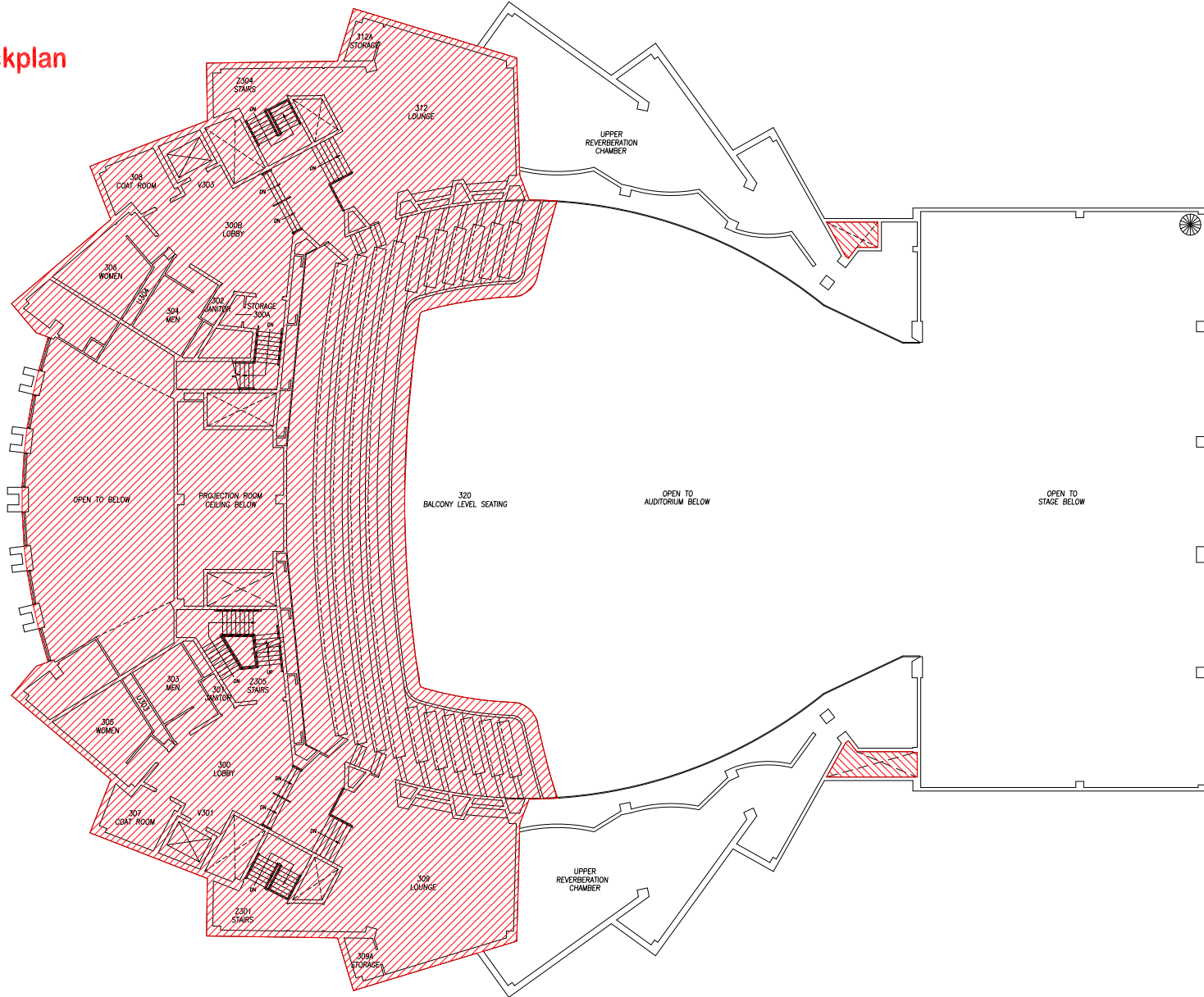

Spray-on Asbestos
Fireproofing / Overspray

Revised: 1/17/13

Call EHS (5-6391) BEFORE accessing
above drop ceilings

Note: Spray-on Asbestos Fireproofing
also assumed to be above all drop
plaster ceilings.

Note: Asbestos Pipe Insulation, Floor
Tile and other information can be
found on the EHS Website:
www.ehs.psu.edu

EISENHOWER AUDITORIUM

THIRD FLOOR PLAN
UNIVERSITY PARK CAMPUS, UNIVERSITY PARK, PA

PENNSTATE



FACILITIES RESOURCES AND PLANNING
THE PENNSYLVANIA STATE UNIVERSITY
BENEDICT HOUSE
UNIVERSITY PARK, PA 16802
OFFICE: 814.865.1595 FAX: 814.865.1610 www.facilities.psu.edu

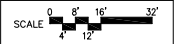

03/17/98 02/18/10
Campus block plans are for referential use
only. Drawings are not to be used for
architectural or engineering purposes.

0011-000

5 OF 7

3



Asbestos Blockplan

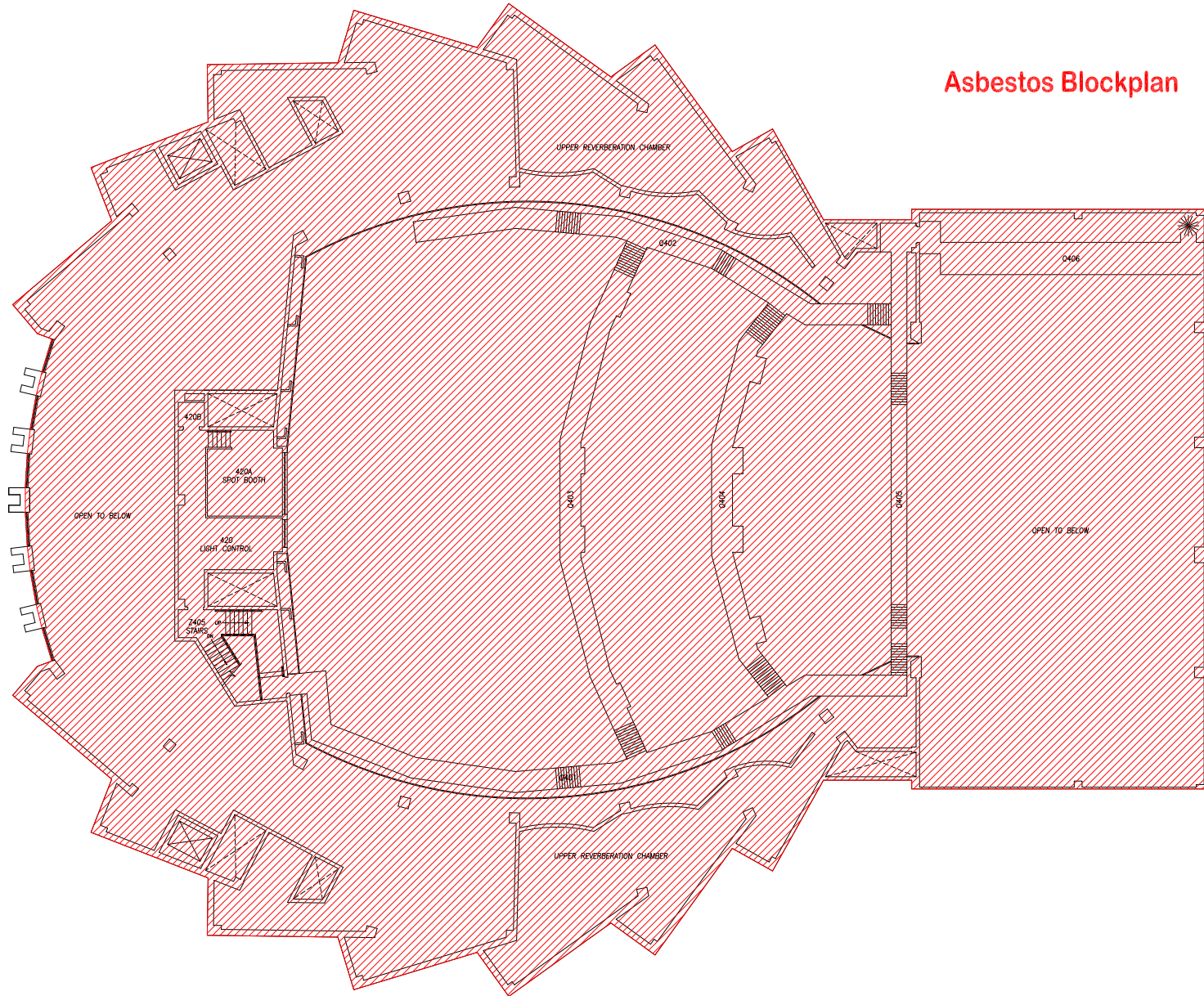

 Spray-on Asbestos Fireproofing / Overspray

Revised: 1/17/13

Call EHS (5-6391) BEFORE accessing above drop ceilings

Note: Spray-on Asbestos Fireproofing also assumed to be above all drop plaster ceilings.

Note: Asbestos Pipe Insulation, Floor Tile and other Information can be found on the EHS Website: www.ehs.psu.edu

EISENHOWER AUDITORIUM

FOURTH FLOOR PLAN
UNIVERSITY PARK CAMPUS, UNIVERSITY PARK, PA

PENNSYLVANIA STATE UNIVERSITY

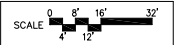

FACILITIES RESOURCES AND PLANNING
THE PENNSYLVANIA STATE UNIVERSITY
BENEDICT HOUSE
UNIVERSITY PARK, PA 16802
OFFICE: 814.865.1595 FAX: 814.865.1610 www.facilities.psu.edu

SCALE 

03/17/98 02/18/10
Campus block plans are for referential use only. Drawings are not to be used for architectural or engineering purposes.

0011-000

6 OF 7

4